

Dunbrik flues

Sample 200mm I.D. straight flue liner system for open fire.

Date: August 2020

Telephone: 01924 373694 Email: tech@dunbrik.co.uk Web: www.dunbrik.co.uk

Ref: **DUN-01-9M**

Notes

Chimney Height of 8980mm from FFL to underside of chimney pot.

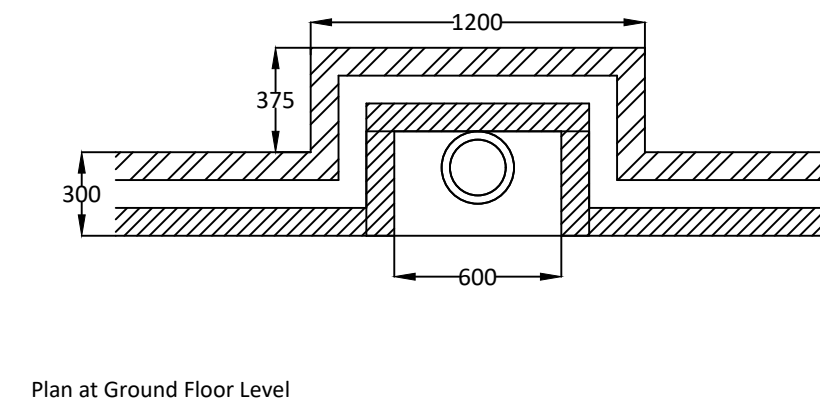
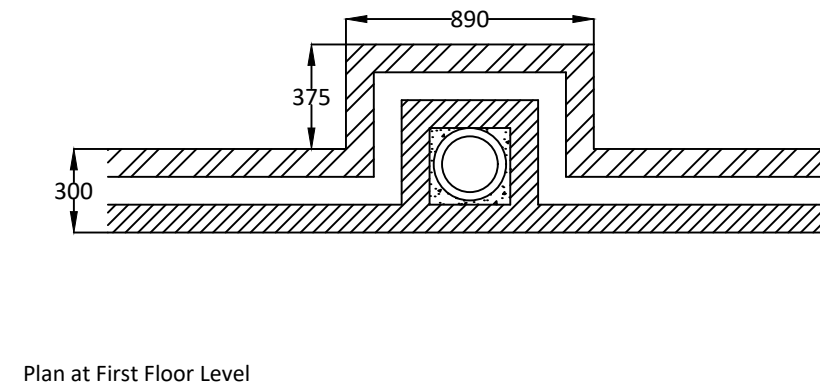
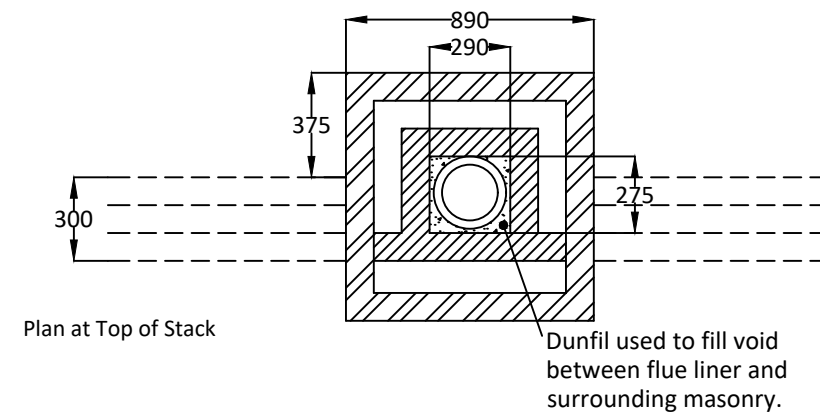
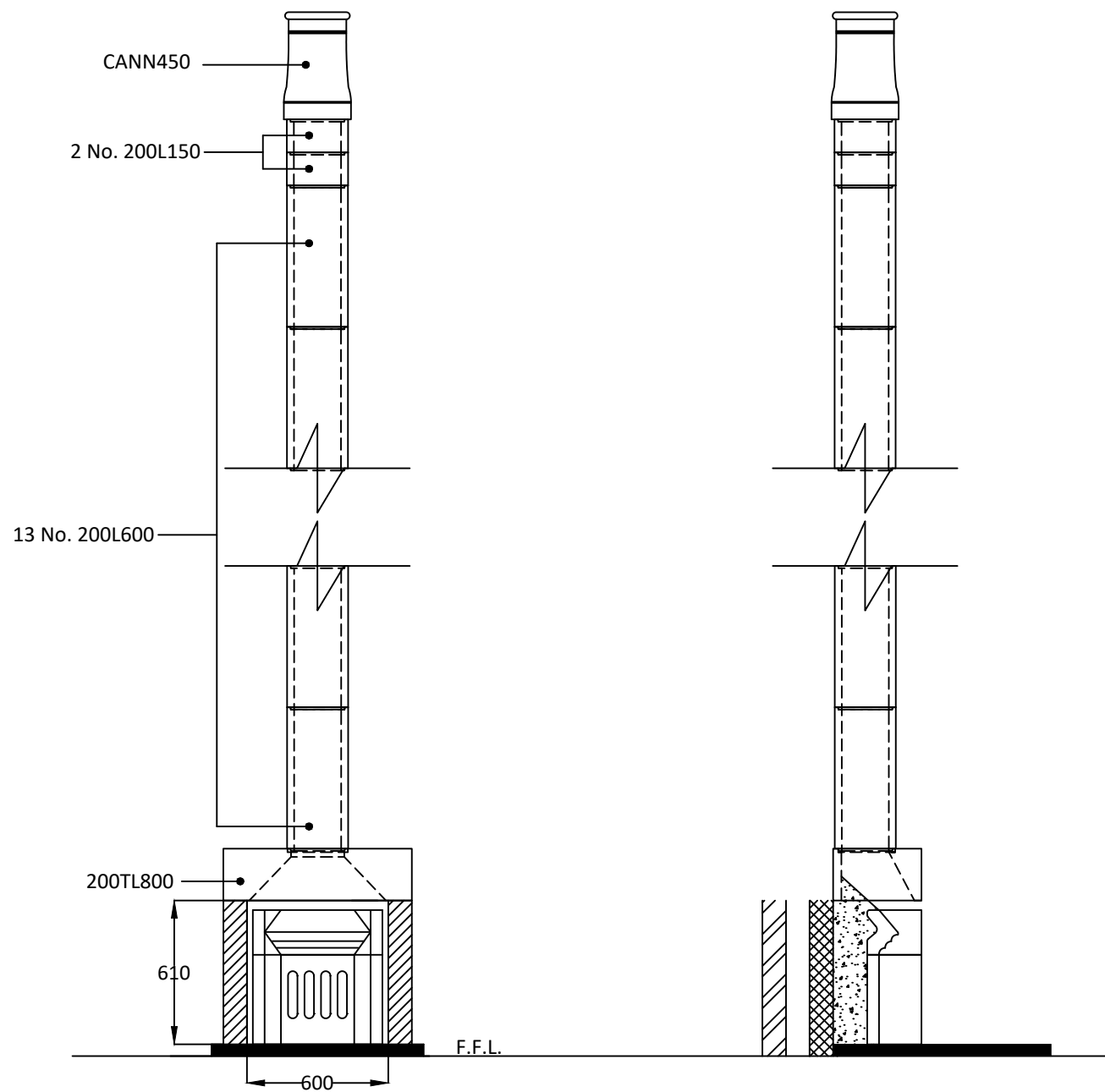

Dunbrik A1 Concrete Flue Liner System to BS EN 1857

Please have your architect check this estimate to your drawings to ensure it meets both your requirements and current building regulations, british standards and codes of practice.

**ALL DIMENSIONS ARE SHOWN IN MILLIMETRES
NOT TO SCALE**

Dunbrik flues

Sample 200mm I.D. straight flue liner system for open fire.

Date: August 2020

Ref: DUN-01-9M

Telephone: 01924 373694 Email: tech@dunbrik.co.uk Web: www.dunbrik.co.uk

Notes

Chimney Height of 8980mm from FFL to underside of chimney pot.

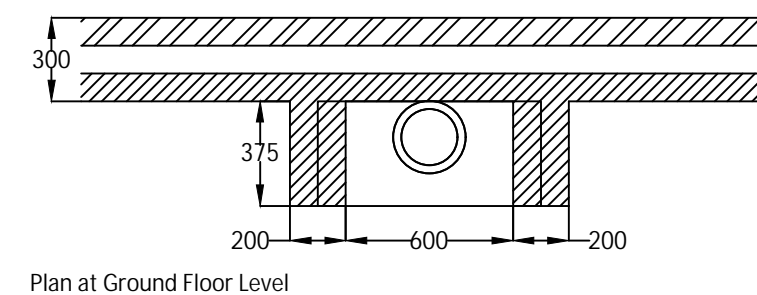
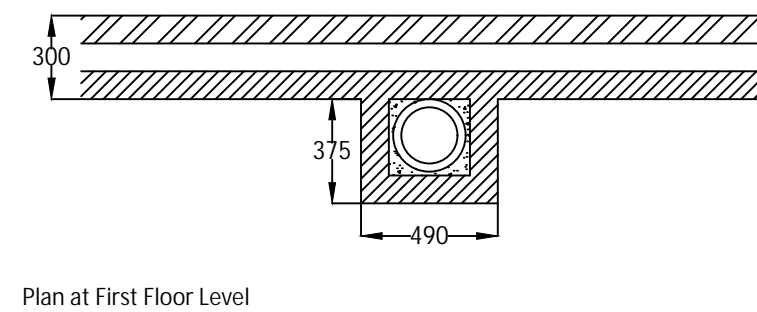
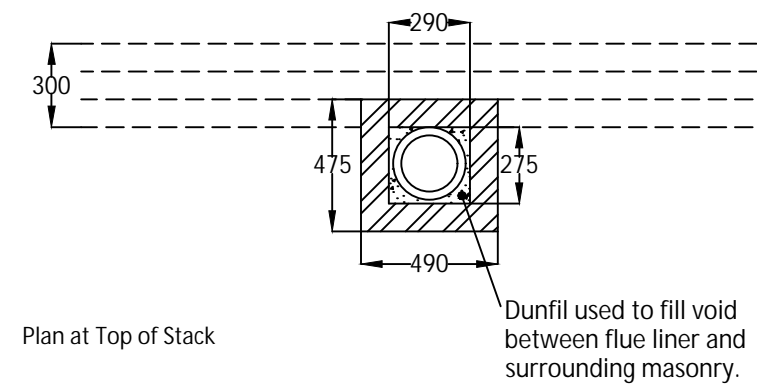
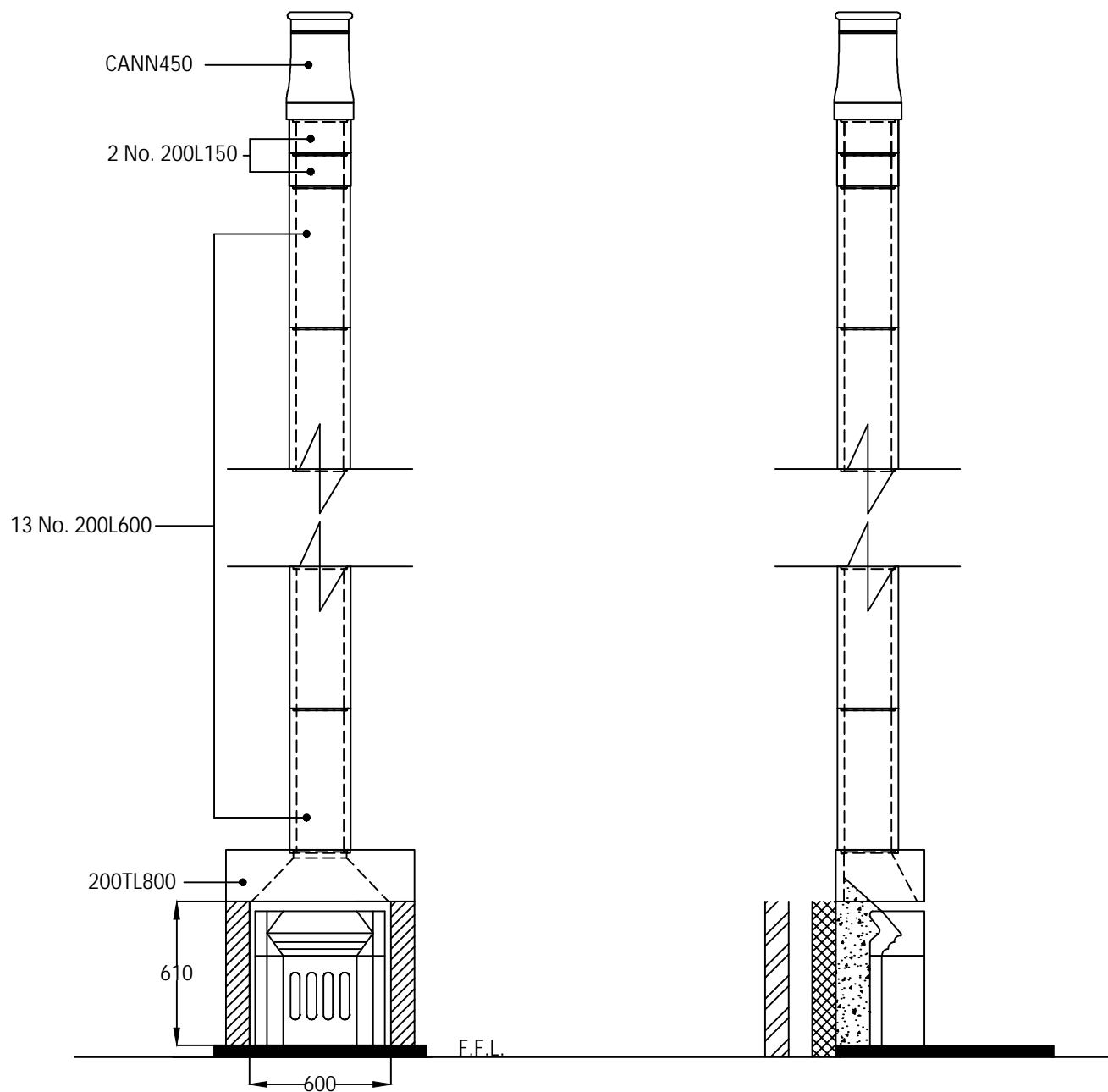

Dunbrik A1 Concrete Flue Liner System to BS EN 1857

Please have your architect check this estimate to your drawings to ensure it meets both your requirements and current building regulations, british standards and codes of practice.

ALL DIMENSIONS ARE SHOWN IN MILLIMETRES
NOT TO SCALE

Costing for: **SAMPLE COSTING**
200mm I.D. Straight flue for open fire.
Chimney height 8980mm from ffl to u/s chimney pot.

Costing ref **DUN-01-9M**
Date 01 August 2020
By SJ
Price list July 2019

| Components | Product code | Qty | Prices each | Cost £ |
|--|--------------|-----|-------------|--------|
| Throat lintel/gather unit 800mm wide | 200TL800 | 1 | 90.24 | 90.24 |
| 200mm flue liner 600mm tall | 200L600 | 13 | 17.85 | 232.05 |
| 200mm flue liner 150mm tall | 200L150 | 2 | 8.43 | 16.86 |
| Flue liner sealant 310ml | Dunseal | 5 | 6.36 | 31.80 |
| Infill aggregate 22kg mix for void | Dunfil | 13 | 13.26 | 172.38 |
| Milner clay fireback 450mm | 450FB | 1 | 99.47 | 99.47 |
| Cannon pot 450mm tall red | Cann450R | 1 | 48.48 | 48.48 |
| Topguard birdguard cowl 260 tall red | TG260R | 1 | 96.53 | 96.53 |
| Smoke pellet tube | Smoke | 1 | 10.80 | 10.80 |
| Flue notice plate | Plate | 1 | 7.36 | 7.36 |
| Red polypropylene air brick 220mm x 72mm | REDG930 | 3 | 0.88 | 2.64 |
| High impact styrene black cavity sleeve 218mm x 72mm | CSG935 | 3 | 4.79 | 14.37 |

| | |
|-----------------|-------------------|
| Cost ex-works * | 822.98 |
| Delivery charge | 95.00 |
| Goods | £ 917.98 |
| VAT @ 20% | 183.60 |
| Total | £ 1,101.58 |

For UK mainland up to 300 miles, orders over £1,700 goods value are delivered free

Charge for individually plotting multiple flue orders is £30 per flue.

* For collection orders add collection charge of £15 plus VAT

Prices shown are based on the Dunbrik ex-works trade price list of July 2019 and are valid for 30 days.

Prices are subject to VAT. All trading is subject to our standard conditions of sale (copy available).

Notes

This flue costing is based on information provided. Please have your architect check the costing to your drawings prior to ordering to ensure that it meets with your requirements. Please also check the pot/terminal style and colour.

For construction guidance refer to the flue illustration and the installation guide available by post, fax or website.

Please ensure that the flue and chimney are constructed in accordance with Building regulations part J

H\Y\W\W\g\h\g\U\g\Y\c\B\6\i\]X\B\ F\Y\i\ U\h\c\g\58>5dd\Y\B\X\] 5" k\h\8i\B\M\] Z\Y\]b\Y\g\g\Y\A\ X\U\U\H\Y\V\i\]X\Y\]b\g\U\Y\F\ 'g\c\i\ X\]b\g\Y\h\X\Y\U\]g\c\Z\H\Y\U\M\U\Z\F\Y\U\W\c\Y\B\]b\] g\h\Y\g\Z\U\M\U\] Y\B\]U\]c\B\]b\g\U\Y\X\U\B\X\U\B\]U\]U\]c\B\g\l\c\H\Y\i\g\i\U\X\U\U'

| | | | |
|--------|---|----------------|---|
| cf | SAMPLE COSTING | 7cghj]b['Yz | DUN-01-9M |
| G]Y'U | | D'c]h]i a VYf | |
| Gng]Ya | Dunbrik 200mm id A1 concrete flue liners | < ci gY'hd]Y | 200mm I.D. Straight flue for open fire. |
| 8UY | 01 Aug 2020 | 7i g]c a Y'fYz | Chimney height 8980mm from ffi to u/s chimney pot. |

Checklist for hearths, fireplaces, flues and chimneys

H\g\W\Y\W\]g\h\W\B\`Y\d\m\i\`l\c\Y\B\g\i\Y\`U\h\g\z\Z\F\Y\U\W\g\z\Z\Y\g\U\B\X\W\]a\B\Y\ng\U\Y\g\U\]g\Z\U\M\c\m\i\Z\m\i\` \U\j\Y\`V\Y\B\X\F\Y\W\i\m\Y\B\]U\]Y\X\ W\]d\]g\g\c\i\X\U\g\c\Y\c\Z\F\Y\X\l\c\H\Y\W\Y\B\h\U\B\l\c\H\Y\6\i\]X\B\] 7\c\B\l\c\`V\c\X\m\c\g\c\k\k\`U\h\m\i\` \U\j\Y\X\c\B\Y\l\c\W\`a\`d\m\k\]h\` 'H\Y\Y\i\g\i\]Y\`a\Y\B\]g\c\Z\U\h\i\`Z\m\i\`U\Y\U\g\i\V\W\B\h\U\M\c\Z\U\W\d\m\g\c\i\X\W\c\Z\F\Y\X\l\c\H\Y\`a\U\]b\W\B\h\U\M\c\`

| Items listed in ADJ Appendix A | Details for builder to complete or amend |
|--------------------------------|--|
|--------------------------------|--|

| | | |
|---|--|--|
| 1 | 6i]X]b[U\X\Y\g\g\z\k\`Y\Y\k\c\L\`U\g\V\Y\Y\B\W\]h\]Y\X\c\i\h | |
|---|--|--|

| | | |
|--|--|--------|
| | | 5a YbX |
|--|--|--------|

| | | |
|---|--|----------------------------|
| 2 | ⇒X]b\]Z\]U\]c\B\c\Z\`Y\U\h\z\Z\F\Y\U\W\z\W\]a\B\Y\m\c\Z\`Y | Fireplace in lounge |
|---|--|----------------------------|

| | | |
|---|--|------------|
| 3 | :]]b[`W\]d\U\]h\m\g\c\X\Z\`Y\`U\g\c\]h\` | All |
|---|--|------------|

| | | |
|---|---|--|
| 4 | ⇒H\Y\B\X\X\h\m\Y\c\Z\U\]d\]U\B\W\`G\H\Y\`h\m\Y\c\`f\`a\U\`Y\` -Z\c\Y\B\Z\]Y\]j\Y\Z\]g\`Y\X\Z\F\Y\U\W\c\Y\B\]b\] X\]a\Y\B\]g\c\B\g\` | For gas fire or solid fuel fire 500mm by 550mm maximum or equivalent area |
|---|---|--|

| | | |
|---|---|--|
| 5 | J\Y\B\]U\]c\B\`d\]c\]g\c\B\g\Z\`f\`h\Y\U\]d\]U\B\W\ G\H\Y\`h\m\Y\U\B\X\U\Y\U\c\Z\`d\]f\`a\U\B\Y\B\h\m\c\Y\B\]U\]f\]Y\B\]g\` | Through wall ventilation 15,700 sq mm minimum |
|---|---|--|

| | | |
|---|--|--|
| 6 | 7\`a\B\Y\m\c\Z\`Y\W\B\g\]f\`W\c\B\ U G\H\Y\`h\Y\`h\m\Y\c\`f\`a\U\`Y\U\B\X\k\`Y\h\Y\`f\`B\Y\k\`c\`f\`Y\]g\]b\] " V\`L\` ⇒H\Y\B\U\`Z\`Y\g\h\Y\`f\`U\B\X\Y\e\i\]j\U\Y\B\h\Z\`Y\`Y\] \]z\k\`Y\Y\ W\W\`U\B\X\B\U\h\i\U\X\U\ [\h\] U\g\U\]d\]U\B\W\g\c\B\`n\i\` W\`Z\]Y\g\U\Y\i\g\Y\X\W\B\Z\`f\`a\`H\Y\m\U\Y\W\]f\Y\W\m\i\c\]h\X\]\`U\W\`f\X\U\B\W\k\]h\`a\`U\B\i\Z\M\i\`f\Y\g\]b\g\]f\`W\c\B\g\U\B\X\ g\H\Y\`c\B\]b\] `a\`U\h\]U\g\i\g\Y\` X\`Z\U\B\Y\]g\]b\] W\]a\B\Y\m\U\g\V\Y\Y\B\`f\Y\Z\`f\Y\g\`Y\X\k\]h\U\ B\Y\k\`]b\Y\Z\h\m\Y\c\`f\`a\U\`Y\c\Z\]b\Y\Z\`W\X\` Y\`L\` 8\Y\U\]g\c\Z\`Y\c\i\h\Y\h\Y\`f\`a\]B\U\ C\i\h\Y\h\X\Y\U\] 7\`c\`a\`d\]Y\g\k\]h\` Z\`B\i\`a\`V\Y\`U\B\X\U\B\]`Y\`c\Z\Y\B\X\g\` [L\`D\]c\]g\c\B\g\Z\`f\`W\U\B\]b\] `U\B\X\Y\W\`a\`Y\B\X\X\Z\`Y\e\i\Y\B\W\]i\` | New masonry chimney with: Dunbrik A1 concrete flue liners to BSEN1857 200mm internal diameter Tongue downwards into rebate and joined with Dunseal fireproof mortar Cannon pot 450mm tall BSEN13502:2002 Annually via fireplace opening |
|---|--|--|

| | | |
|---|---|---------------------------------|
| 7 | <Y\U\h\`":`c\`f\`a\`c\Z\W\B\g\]f\`W\c\B\`B\Y\k\`c\`f\`Y\]g\]b\] | New As diagram 25 in ADJ |
|---|---|---------------------------------|

| | | |
|---|--|---------------------------------|
| 8 | ⇒g\]d\Y\W\c\B\U\B\X\]Y\g\]b\] `U\Z\]f\`W\`a\`d\]Y\]c\B\ H\Y\g\]f\`5\`d\]d\]Y\B\X\] 9\]B\]58>`&S\`S\`&L\`U\B\X\]f\Y\g\]i\g\ :`i\Y\]b\g\]d\Y\W\c\B\`f\Y\g\]i\g\ J\]g\]U\ G\k\Y\Y\]d\]b\] 7\`c\]f\]b\] `V\U\` G\`a\`c\`_`Y\ G\]d\]U\]Y\` 5\`d\]U\B\W\`f\`k\`Y\`f\]b\W\`X\X\]i\` | H\Y\g\]g\`W\]h\]Y\X\c\i\h\W\m\` |
|---|--|---------------------------------|

I/We the undersigned confirm that the above details are correct. In my opinion, these works comply with the relevant requirements in Part J of Schedule 1 to the Building Regulations.

| | |
|---|----------------------------------|
| D\]f\]b\]h\]U\`a\`Y\`/`H\]Y\` _____ | D\]f\]c\]Z\]Y\g\]g\]c\]b\` _____ |
| 7\`U\]d\]U\]M\] _____ | H\`Y\`bc\` _____ |
| 5\`X\]f\]Y\g\]g\` _____ | D\]c\]g\]W\]X\]Y\` _____ |
| G\]l\]b\]Y\X\` _____ | 8\`U\]Y\` _____ |
| F\]Y\]g\]h\]Y\]X\`a\`Y\`a\`V\]f\]g\]d\]c\]Z\]f\]l\]`":`U\]g\]U\]Z\]m\]c\]C\]H\]9\]Z\`<9\]H\]5\]G\]Z\]B\]5\]7\]9\]Z\]B\]5\]7\]G\]L\` | |